

## **50-B-51 - SPEEDLINE System Data Sheet - Version V1 (24-10-23)**

SPEEDLINE 50mm 'C' Stud Partition @600mm Ctrs,  
 with BG Gyproc 12.5mm WallBoard each side

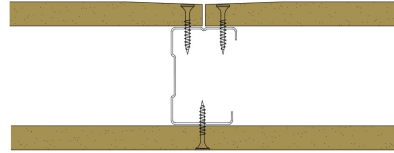

### **System Performance Breakdown**

Fire Resistance:

BS476 Part 22:1987:

Test Ref & Date or Applied Ref & Report:

Max Height:

Thickness:

Duty Grade: BS 5234: Part 2:1992:

Sound Insulation:

**30/30 Minutes** (Integrity/Insulation).

**BTC 17439F - 24/08/2011 - BRE Report P102396-1011A**

**Refer to Speedline Specification Clause**

**77 mm.** (At Base Track, Excluding Finishes)

**Medium - Annexes A-F**

**NA  $R_w$ dB**, Date Tested or Assessed Against -

TESTED AT ONE OF THE UKAS  
 ACCREDITED LABORATORIES  
 BELOW

B.T.C  
 (H-Ref on Graph)



B.R.E



AIRO



S.R.L

